



# 6026-Z Deep groove ball bearings

- SKF Explorer

## Deep groove ball bearings

### Bearing data

[Tolerances](#),

Normal (metric), P6, P5, Normal (inch),

[Radial internal clearance](#),

Matched bearing pairs, Stainless steel  
d < 10 mm, Other bearings

### Bearing interfaces

[Seat tolerances for standard conditions](#),

[Tolerances and resultant fits](#)

## Technical specification

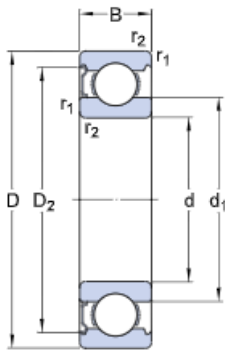

### DIMENSIONS

d	130 mm	Bore diameter
D	200 mm	Outside diameter
B	33 mm	Width
d <sub>1</sub>	≈ 152.6 mm	Shoulder diameter
D <sub>2</sub>	≈ 181.4 mm	Recess diameter
r <sub>1,2</sub>	min. 2 mm	Chamfer dimension

### ABUTMENT DIMENSIONS

d <sub>ε</sub> min.	139 mm	Diameter of shaft abutment
d <sub>ε</sub> max.	152.9 mm	Diameter of shaft abutment
D <sub>ε</sub> max.	191 mm	Diameter of housing abutment
r <sub>a</sub> max.	2 mm	Radius of shaft or housing fillet

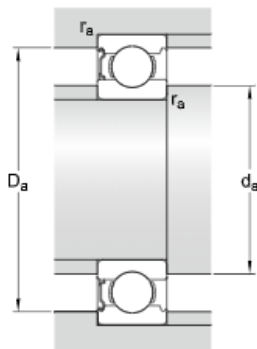

## CALCULATION DATA

C	112 kN	Basic dynamic load rating
C <sub>0</sub>	100 kN	Basic static load rating
P <sub>u</sub>	3.35 kN	Fatigue load limit
	7 000 r/min	Reference speed
	4 300 r/min	Limiting speed
k <sub>r</sub>	0.025	Minimum load factor
f <sub>0</sub>	15.8	Calculation factor

## MASS

	3.32 kg	Mass bearing
--	---------	--------------

## TOLERANCE CLASS

P6	Dimensional tolerances
Normal	Radial run-out